

OTTAWA[®]



REF :
DT040 / DT041 / DT048 / DT049

Version shown
DT041SD (steel dark plate finish)

Category
Dining Table

For use
Interior

Dimensions available
DT040 / DT041 : 190/270 x 100 x h76 cm
DT048 / DT049 : 150/230 x 100 x h76 cm

DT048 / DT049

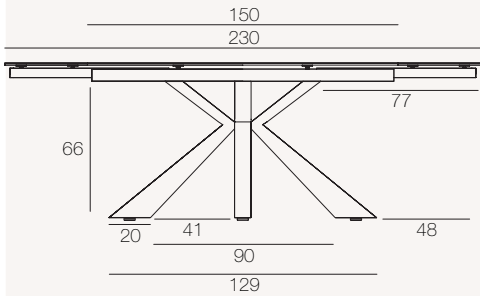

DT040 / DT041

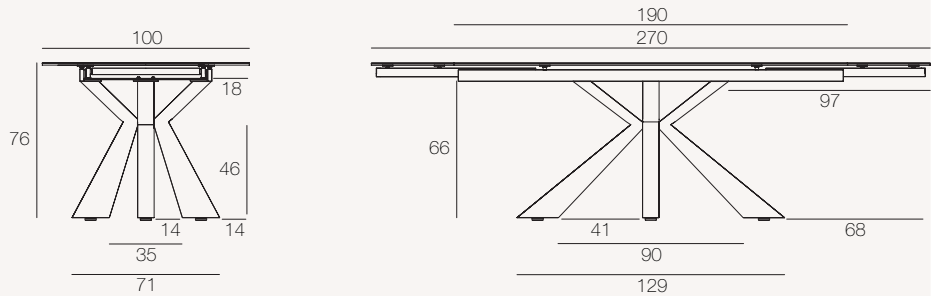

Unit : centimetre

MECHANISM

Manual system of independent 40 cm side extensions

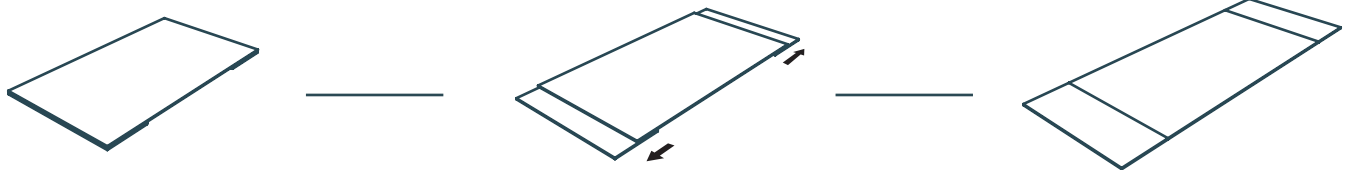

DT048 / DT049 : Up to 6 places
DT040 / DT041 : Up to 8 places

DT048 / DT049 : Up to 8 places
DT040 / DT041 : Up to 10 places

FINISHES

Ceramic top :

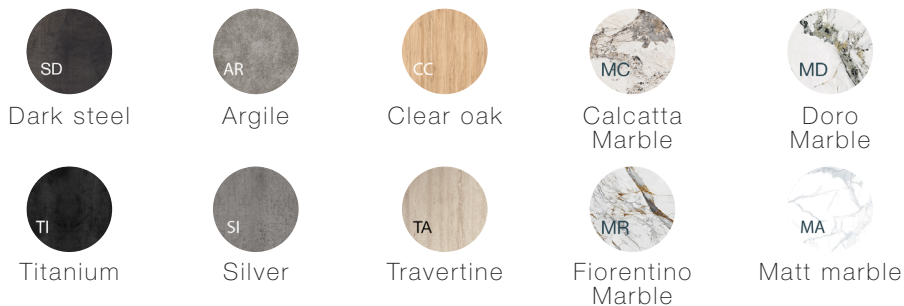

Legs :

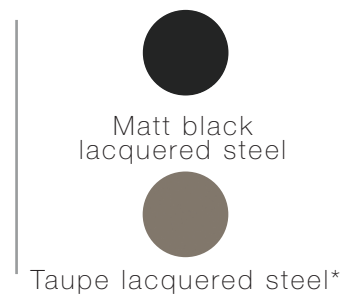

*Only available with
Matt Marble and Argile

AKANTE[®]

www.akante.com

TECHNICAL INFORMATION

Top plate :

3 or 6 mm ceramic bonded to 8 mm glass.

Legs :

Black Powder-coated steel*

Taupe Powder-coated steel*

*Powder coating is a «dry» spraying technique that uses no solvents that are harmful to people or the environment. This technique complies with European REACH regulations, which control the use of chemicals in industry.

Skids :

Adjustable glides to ensure stability

Assembly time :

15 minutes

© Registered design (INPI : 20222320)

PACKAGING

DT048/DT049 (Size : 150/230 x 100 x h76 cm)

	Plate	Legs	Total
Number of packages	1 package	1 package	2
Gross weight (Product + packaging)	100,5 kg	31 kg	131,5 kg
Net weight	89 kg	28,5 kg	117,5 kg
Package size	159 x 108 x 17 cm	106 x 86 x 15 cm	

DT040/DT041 (Size : 190/270 x 100 x h76 cm)

	Plate	Legs	Total
Number of packages	1 package	1 package	2
Gross weight (Product + packaging)	113,5 kg	31 kg	144,5 kg
Net weight	99,5 kg	28,5 kg	128 kg
Package size	199 x 108 x 18 cm	106 x 86 x 15 cm	

