

# ALTO

CT575

CT576

REF :  
CT575 / CT576

**Versions shown**  
CT575MM / CT576CC

**Category**  
Coffee Table

**For use**  
Interior

**Dimensions available**  
100 x 68 x h44-64 cm

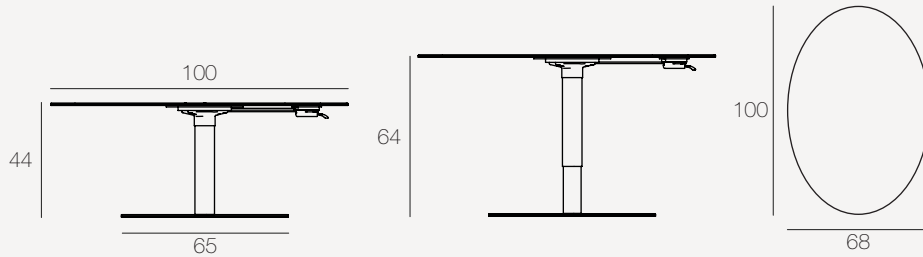

Unit : centimetre

## MECHANISM

Press the handle located under the tabletop to lower and raise the table.

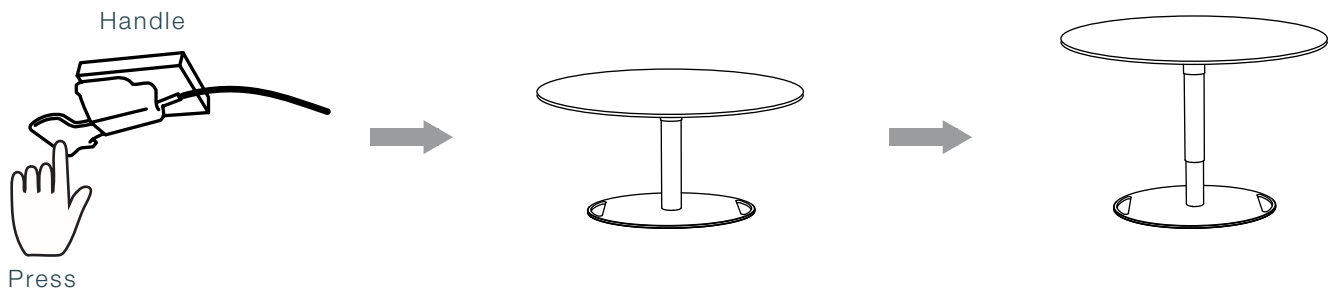

## FINISHES

**Tabletops :**



Argile



Clear oak



Marquina  
Marble



Matt marble



Titanium



Silver



Dark steel



Calcutta  
Marble

**Legs :**



Matt black lacquered steel



Matt white lacquered steel

  
AKANTE®

[www.akante.com](http://www.akante.com)

## TECHNICAL INFORMATION .....

### Tabletops:

3 mm ceramic bonded to 6 mm glass,  
and/or 11 mm full-body ceramic.

### Legs :

White and black Powder-coated steel\*.

\*Powder coating is a «dry» spraying technique that uses no solvents that are harmful to people or the environment. This technique complies with European REACH regulations, which control the use of chemicals in industry.

### Handle:

Press the handle located under the tabletop  
to adjust the height of the table.

### Gliders:

Adjustable gliders to ensure stability.

### Assembly time :

15 minutes

**Net weight : 35.5 kg**

## PACKAGING .....

CT575 / CT576 (Size: 100 x 68 x h44-64 cm)

	Plate	Tube	Base	Total
Number of packages	1	1	1	3
Gross weight (Product + packaging)	20 kg	2.7 kg	16 kg	38.7 kg
Net weight	19 kg	2.5 kg	14 kg	35.5 kg
Package size	122 x 71 x 4 cm	48 x 20 x 20 cm	75 x 57 x 85 cm	

